

MJ Nozzle Technology

mastip[™]
hot runner solutions



The MJ nozzle is ideal for the processing of small parts or where space is minimal.

Designed for multi cavity hot half configurations the nozzle has optimised thermocouple and heater positioning to ensure precise temperature control and profile. A small gate pocket requirement allows injection into restricted areas while enabling superior cooling of the gate area, thus providing improved part quality and cycle times.

Its flexible front loading heater, thermocouple and tip design ensures any future maintenance requirements can be performed hassle free, helping you reduce machine downtime and costs.

Mould Design

- Efficiently designed nozzle pocket profile for improved cooling performance and gate strength
- Optimum flow characteristics give ability to mould parts with ease
- Able to achieve close pitching due to efficient nozzle design

Operation

- Wide moulding window
- Excellent temperature profile and thermal stability
- Operates at low moulding pressure and temperature
- Superior thermal insulation to improve cycle times

Installation and Maintenance

- Simple installation requirements
- Default long life tip materials
- Frontloading capability for easy servicing
- Improved reliability due to the use of advanced materials

MJ Nozzle Technology

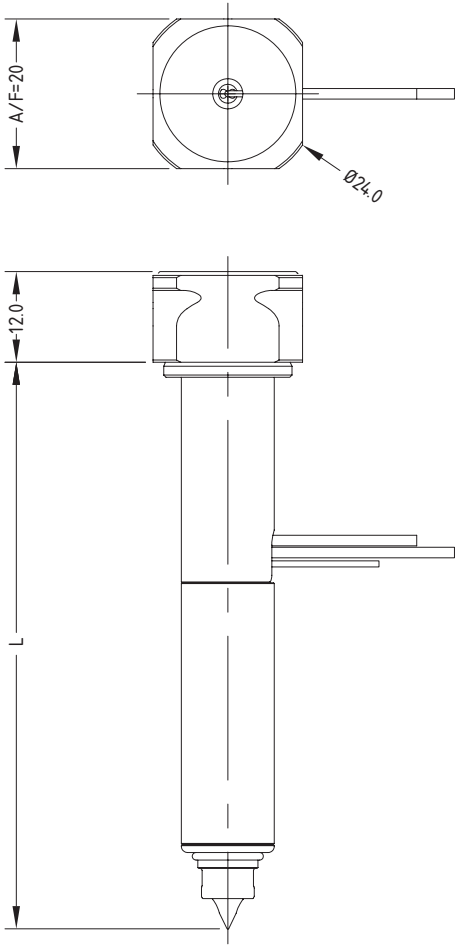

Availability

MJ09 Series	
L	75
	95
	115
	130
	145
	175

All measurements are in millimetres.

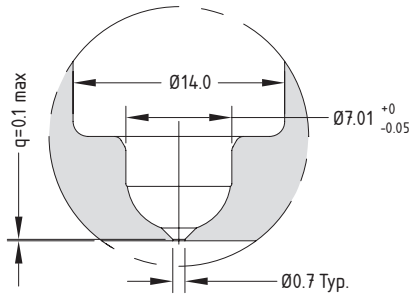

Gating Options

